



SERIES 'ECI' & 'ESS' VERTICAL PUMPS



*Series 'ESS' Pump
with optional mounting plate*

High efficiency and low energy usage for:

ACIDS WET PROCESSING SOLUTIONS FUME SCRUBBERS CLEANING SOLUTIONS

- Flows to 180 U. S. GPM or 90 ft. TDH @ 60 Hz (565 LPM or 19.5m @ 50 Hz)
- Standard column length is 13" Available in 20", 32" and 44" lengths
- Available in cast iron or all 316 stainless steel solution contact
- Available in two sizes - 1¼" x 1" and 2" x 1½" NPT
- Motors are standard NEMA 'C' face (.75 - 5.0 HP)
- Centrifugal — quiet, vibration-free
- Shaft vapor seal protects motor bearings and atmosphere

The Series 'ECI' and 'ESS' Vertical Pumps feature a high efficiency semi-open impeller, cast construction for superior strength and corrosion resistance, and a cantilevered 316 stainless steel shaft guided by a graphite or Rulon® bushing. This same bushing design and unique column assembly allows for reliable operation with columns up to 44".

The bushing is lubricated by the product being pumped, thus no external flushing liquid is required. However, since the bushing is being product flushed, these pumps must be used inside the tank. The optional heavy duty mounting plate uses a clamp arrangement which allows it to be positioned anywhere along the length of the pump column. The optional discharge pipe then fits through the mounting plate for easy drop-in installation.

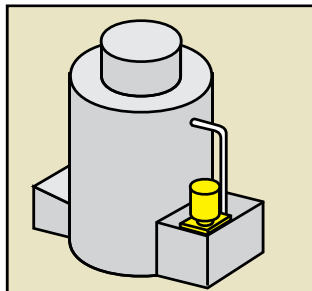

FUME SCRUBBING
SUMP DRAINING

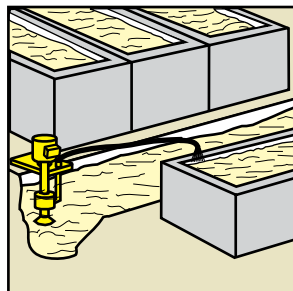

CHEMICAL

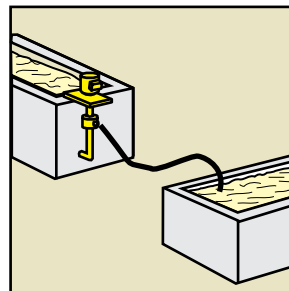

TRANSFERRING
PCB WET PROCESSING

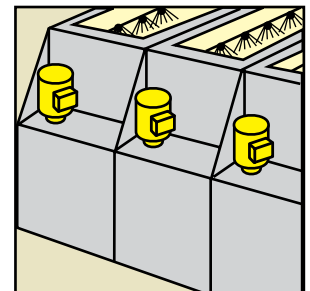

or CLEANING SOLUTIONS



2900 MacArthur Blvd. Northbrook, IL. USA 60062 www.serfilco.com (800) 323 - 5431

Pumps are constructed of 316 stainless steel throughout for maximum corrosion resistance. Gasket is a synthetic fiber with cast iron, Teflon® with 316 SS, shaft vapor seal is Viton®. Shaft is available in four lengths to 44". Graphite or Rulon® shaft bushing provides vibration-free service and is located directly above the semi-enclosed high efficiency impeller, therefore, it is product flushed. Optional mounting plate can be clamped and tightened

at any given point on the pump column, which allows the pump to be set at the desired depth. Motors are 3450 RPM @ 60 Hz or 2850 @ 50 Hz, TEFC or EXP. Single phase TEFC motors include 8 ft. (2.4m) line cord.

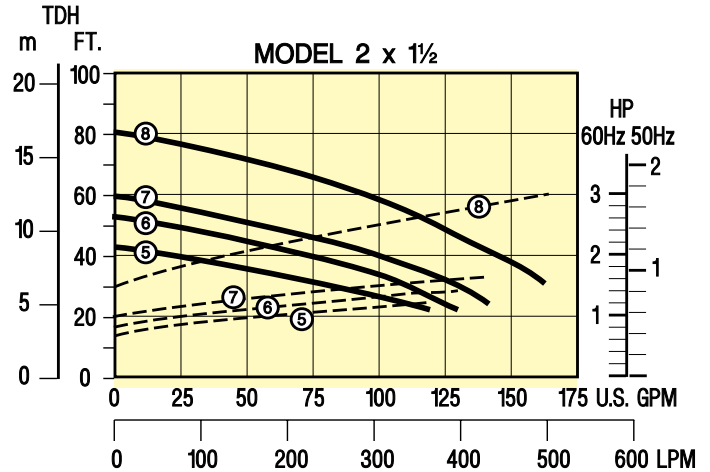
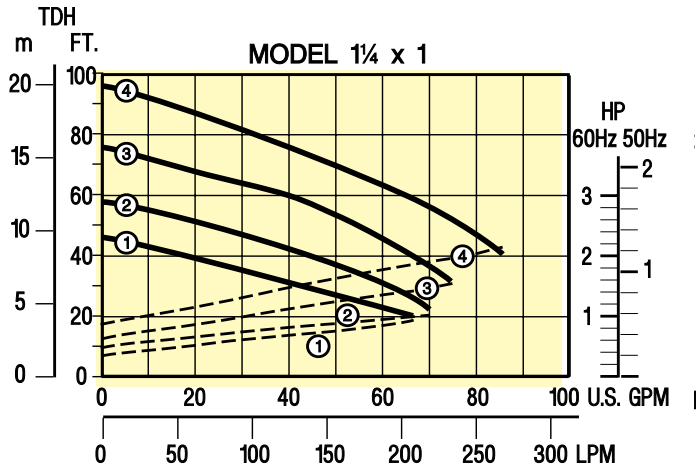

DIMENSIONS

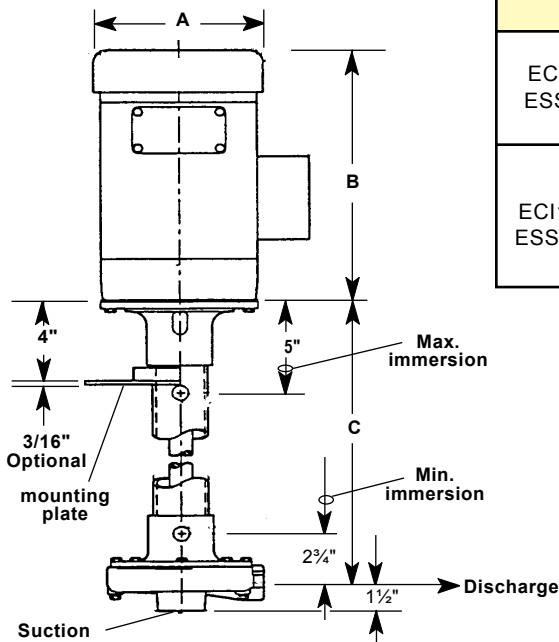

MODEL	HP	SUC. NPT (In.)	DISCH. NPT (In.)	DIMENSIONS Inches						WEIGHT Lbs.(kg.)
				A	B	C	D	E	F	
ECI1 ESS1	3/4	1-1/4	1	6-1/8	9-1/4	13	2-3/4	3-1/2	6-5/8	59 (27)
	1			6-1/8	9-3/4	20				63 (28)
	1-1/2			7-1/4	10-1/2	32				69 (31)
	2			7-1/4	11-1/8	44				85 (39)
ECI1 1/2 ESS1 1/2	1	2	1-1/2	6-1/8	9-3/4	13	3-1/8	3-3/4	7-7/8	63 (28)
	1-1/2			7-1/4	10-1/2	20				80 (36)
	2			7-1/4	11-1/8	32				85 (38)
	3			7-1/4	12-3/8	44				88 (40)
	5			8-1/2	13-5/8				103 (47)	

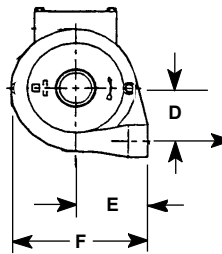

BOTTOM VIEW



TO ORDER

TABLE I

Select 13" long pump-motor model from flow curve number providing the desired performance. Motor HP is non-overloading at full flow, for 1.0 specific gravity and 60 Hz operation. Graphite bushing.

ESS1 PUMP - MOTOR (230/460/3/50-60) 13" 'C' length		
FLOW CURVE NO.	MODEL NUMBER	PRICE CODE NO.
1	ESS1-1-13"C-G-D1.0	61-1011-E
2	ESS1-2-13"C-G-D1.5	61-2011-F
3	ESS1-3-13"C-G-D2.0	61-3011-G
4	ESS1-4-13"C-G-D3.0	61-4011-H
ESS1½ PUMP - MOTOR (230/460/3/50-60) 13" 'C' length		
5	ESS1½-5-13"C-G-D1.5	62-5011-F
6	ESS1½-6-13"C-G-D2.0	62-6011-G
7	ESS1½-7-13"C-G-D3.0	62-7011-H
8	ESS1½-8-13"C-G-D5.0	62-8011-J

TABLE II

Determine pump-motor model for a specified GPM, TDH, length, bushing and specific gravity. Select performance point on curve and size HP from corresponding number dotted line vertically above or below performance point. Read required HP at right ordinate and multiply by specific gravity. Select pump model components and Price Code Numbers from Table II.

PUMP		IMPELLER			LENGTH		
MODEL	PRICE CODE NO.	FLOW CURVE NO.	ADD TO ...		C DIM.	ADD TO ...	
			MODEL	PRICE CODE NO.		MODEL	PRICE CODE NO.
ECI1	61-	1	1	1	13"	13"C	01
ESS1		2	2	2	20"	20"C	02
ECI1½		3	3	3	32"	32"C	03
ESS1½		4	4	4	44"	44"C	04
	62-	5	5	5			
		6	6	6			
		7	7	7			
		8	8	8			

MATERIAL

PUMP	BUSHING	ADD TO ...	
		MODEL	PRICE CODE NO.
ESS 316SS	Graphite	G	1
	Rulon	R	2
ECI CI	Graphite	G	3
	Rulon	R	4
	None ¹	-	5

¹ Standard 13" CI pump does not have a bushing
² For explosion-proof motors (UL and CSA listed for Class I, Group D or Class II, Groups F & G.), add **X** to Model No. and Price Code No. EXP motors are 60 Hz only.

TEFC MOTOR² (3450 or 2850)

HP	SINGLE PHASE ³		THREE PHASE ³	
	ADD TO ...			
	MODEL	PRICE CODE NO.	MODEL	PRICE CODE NO.
.75	-C.75	-A	-D.75	-D
1	-C1.0	-B	-D1.0	-E
1.5	-C1.5	-C	-D1.5	-F
2.0	—	—	-D2.0	-G
3.0	—	—	-D3.0	-H
5.0	—	—	-D5.0	-J

³ Single phase - 115-208-230V/1/60 or 220-440V/1/50
 Three phase - 208-230-460V/3/60 or 380-415V/3/50

OPTIONAL EQUIPMENT

DESCRIPTION	ADD SUFFIX to MODEL NO.	USE SEPARATE PRICE CODE NO.	
Mtg. plate (12"x12" w/hole for disch. pipe assy.) Steel 304 stn. steel	-MP	61-1000 61-2000	
Discharge pipe assy. 1" NPT for ESS1 1½" NPT for ESS1½	-DPA1	61-1001	
	-DPA1½	61-1002	
	1" NPT for ECI1 1½" NPT for ECI1½	-DPA1	61-1003
		-DPA1½	61-1004



PERFECT PUMPS FOR CHEMICALS

Proudly Made in the USA, SERFILCO Offers the Widest Range of Chemical Pumps Anywhere.

'EH' Vertical Pump

- Can Run Dry
- Extended Column to 10'
- Flows to 185 gpm, 145 ft. TDH



'HE' Horizontal Pump

- Single or Double Mech. Seal
- Variety of Material Types
- Flows to 175 gpm, 140 ft. TDH



'ME' Magnetic Coupled Pump

- Seal-less Magnetic Coupled
- Polypropylene or PVDF
- Flows to 95 gpm, 54 ft. TDH



'EF' Vertical Pump

- Can Run Dry
- Suction Extension to 3'
- Flows to 400 gpm, 170 ft. TDH



'HF' Horizontal Pump

- Single or Double Mech. Seal
- Variety of Material Types
- Flows to 400 gpm, 160 ft. TDH



'FE' Magnetic Coupled Pump

- Seal-less Magnetic Coupled
- Polypropylene or PVDF
- Flows to 130 gpm, 97 ft. TDH



'EHM' Vertical Pump

- Can Run Dry
- Suction Extension to 3'
- Flows to 650 gpm, 115 ft. TDH



'HA' Horizontal Pump

- Single or Double Mech. Seal
- Machined from Solid CPVC
- Flows to 1200 gpm, 115 ft. TDH

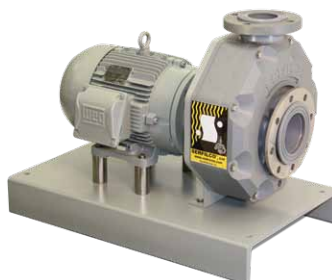

'FES' Magnetic Coupled Pump

- Seal-less Magnetic Coupled
- Polypropylene or PVDF
- Flows to 250 gpm, 175 ft. TDH

